

**Electrical**

Item	Test Condition (at 25°C±5°C)	Specification
Impedance	DC-500 MHz	Non-Constant
Dielectric Withstanding Voltage (Between Center Cond. & Inter Cond.)	AC, time: 60sec	1200 Vrms Min.
Dielectric Withstanding Voltage (Between Inter Cond. & Outer Cond.)	AC, time: 60sec	500 Vrms Min.
Insulation Resistance	DC 500V, time: 120sec	5000 MΩ Min.

**Mechanical**

Item	Test Condition	Specification
Force to Engage/ Disengage	N/A	2.5 in-lbs. Max. / 8 lbs. Max.
Coupling Nut Retention	60mm/min	100 lbs Min.
Contact Retention	60mm/min	6 lbs. Min.

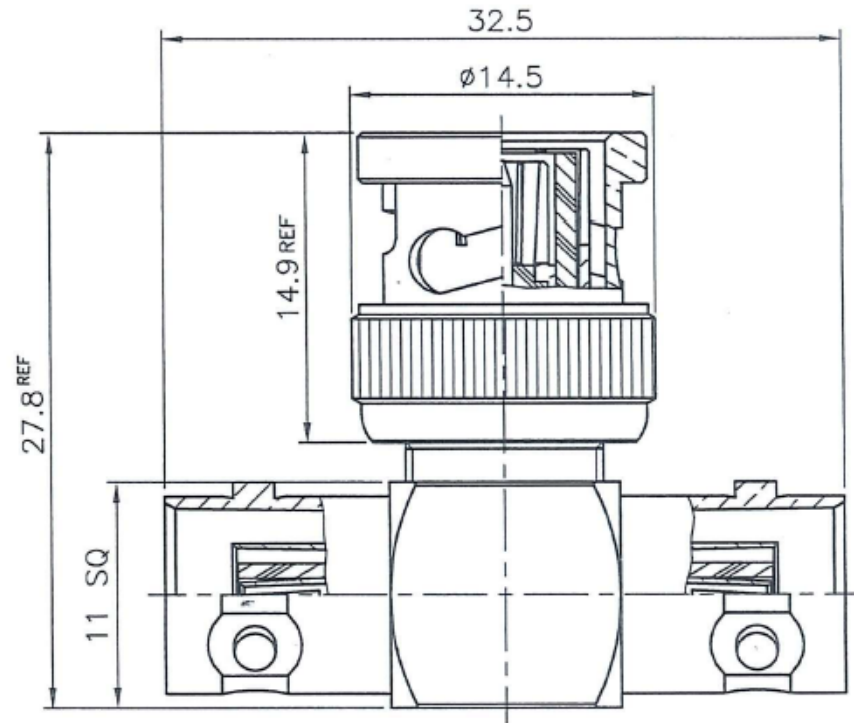

NO.	DESCRIPTION	MATERIAL	FINISH
1	SHELL	BRASS	NICKEL
2	GASKET	SILICONE	RED
3	C RING	SS41	NICKEL
4	SPRING	SK5	NICKEL
5	WASHER	SS41	NICKEL
6	CONTACT PIN	BRASS	GOLD
7	INSULATOR	PTFE	WHITE
8	CONTACT BODY	PHOSPHOR BRONZE	GOLD
9	INSULATOR	PTFE	WHITE
10	BODY	BRASS	NICKEL
11	LOCK RING	BRASS	NICKEL
12	LOCK RING	BRASS	NICKEL
13	CONTACT PIN	BERYLLIUM COPPER	GOLD
14	INSULATOR	PTFE	WHITE
15	CONTACT BODY	BRASS	GOLD
16	INSULATOR	PTFE	WHITE
17	BODY	BRASS	NICKEL

RoHS Compliant	Cd ≤75ppm
REMARKS	BRASS: Cd ≤75ppm PHOSPHOR BRONZE: Pb <4wt%

SCALE NONE		PART NUMBER
UNIT mm		TRB-TA-JPJ
DATE 2024/11/10	PROJECTION 	TO-CONNE CO.,LTD