

STAMP : 2.92

STAMP : 3.5

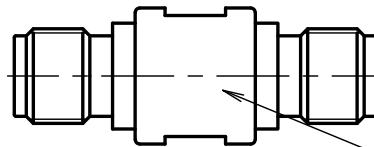
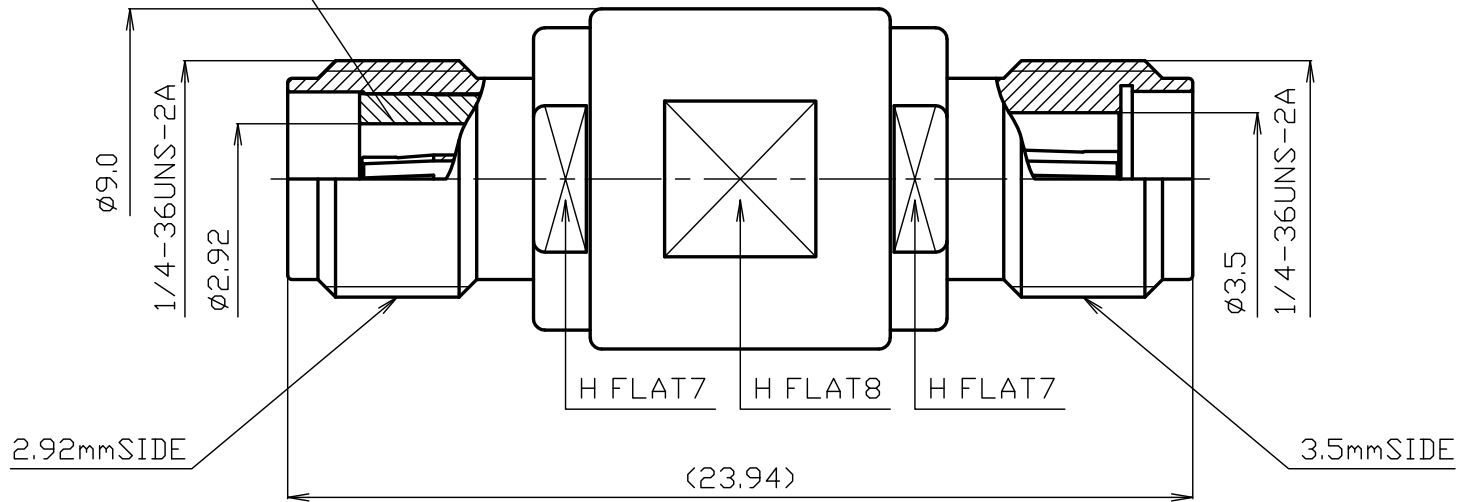

STAMP : TYC

- \* 1 : PASSIVATE
- \* 2 : STAINLESS STEEL
- \* 3 : BERYLLIUM COPPER

RoHS Compliant [Cd ≤75ppm]

REMARKS BRASS: Cd ≤75ppm  
PHOSPHOR BRONZE: Pb <4wt%

| NO. | DESCRIPTION | MATERIAL    | Q'TY | FINISH | REMARK | SCALE      | DRAWN      | INSPECTED | APPROVED  | CHECKED   | PART NUMBER           |
|-----|-------------|-------------|------|--------|--------|------------|------------|-----------|-----------|-----------|-----------------------|
| 7   |             |             |      |        |        | 5/1        | 上          | 檜         | 山         | 三         | K292J-3.5J            |
| 6   |             |             |      |        |        |            | '24.02.29  | '24.02.29 | '24.02.29 | '24.02.29 |                       |
| 5   |             |             |      |        |        | mm         | 領          | 澤         | 本         | 村         |                       |
| 4   | BUSHING     | *2          | 1    | *1     |        |            |            |           |           |           |                       |
| 3   | INSULATOR   | EPOXY RESIN | 1    | *1     |        |            |            |           |           |           |                       |
| 2   | CENTER PIN  | *3          | 1    | Au     |        |            |            |           |           |           |                       |
| 1   | BODY        | *2          | 1    | *1     |        |            |            |           |           |           |                       |
|     |             |             |      |        |        | DATE       | PROJECTION |           |           |           | DRAWING NO. U-0646470 |
|     |             |             |      |        |        | 2024.02.29 |            |           |           |           | GKQM-22               |

# PRODUCT SPECIFICATIONS

Part number : K292J-3.5J

No. 0642625

Drawing number : U-0646470

Nominal 1 Standard IEC 61169-35(2.92mm)、IEC 61

- 2 Voltage rating AC 335
- 3 Rated frequency 34GHz
- 4 Impedance 50Ω
- 5 Operating temperature range -40°C~+85°C



|    |  | Test Items                             | Test Method/Value  | Remarks  |
|----|--|--|--|--|
| 1  | E<br>L<br>E<br>C<br>T<br>R<br>I<br>C<br>A<br>L | Insulation resistance                  | 5000MΩ(Min.) at DC 500V  |  |
| 2  |  | Withstanding voltage                   | 1 minute at AC 750V  |  |
| 3  |  | Contact resistance                     | Inner conductor : 3.0mΩ(Max.)<br>Outer conductor : 2.0mΩ(Max.) |  |
| 4  |  | V.S.W.R                                | DC~34GHz : 1.3(Max.)   |  |
| 5  | M<br>E<br>C<br>H<br>A<br>N<br>I<br>C<br>A<br>L | Compatibility                          | No defects or abnormalities                                    | Connecting with a standard-compliant connector |
| 6  |  | Tensile strength of coupling mechanism | 180N   | At axial tensile force                         |
| 7  |  | Center contact retaining force         | 0.4N(Min.)(2.92mm)<br>0.55N(Min)(3.5mm)                        | With a standard pin gauge                      |
| 8  |  | Coupling torque                        | 0.8~1.1N·m   |  |
| 9  |  |  |  |  |
| 10 | O<br>T<br>H<br>E<br>R<br>S                     |  |  |  |
| 11 |  |  |  |  |

※The structural shape is shown in the attached drawing (Drawing numberU-0646470)

|   | REVISIONS | DATE |
|---|-----------|------|
| 1 |           |      |
| 2 |           |      |
| 3 |           |      |

| Checked           | Approved          | Inspected         | Prepared          |
|-------------------|-------------------|-------------------|-------------------|
| <br>24.02.29<br>村 | <br>24.02.29<br>本 | <br>24.02.29<br>澤 | <br>24.02.29<br>額 |

GKQM-24